



Reef Filter 100nano

INSTRUCTIONS
ENGLISH ONLY



SPECIFICATION



	Code	1434
Model / Modelo/ Modelo/Modell/Model/Modello/ Modèle		Reef Filter 100nano
Flow Rate /Taxa de fluxo/Tasa de flujo / Fließrate/Stroom/Portata/ Débit		250l/h
Max. Power / Potência máx./Potencia Max./ Max. Leistung/Max. Kracht/Potenza min./ Puissance Max.		5W
Voltage / Voltagem/ Voltaje/Spannung/Spannin/Voltaggio/ Tension		5V DC
PSU Voltage / Voltagem do PSU/ Voltaje de PSU/Netzteilspannung/Voedingsspanning PSU/Voltaggio alimentatore PSU/ Tension d'alimentation PSU		100-240V 50/60Hz
	Max. Media	150ml*
	Approx. dimensions	100 x 65 x 300mm

*based on 150ml phosphate removing media

PART LIST



1. Body Hanger
2. Main body
3. Centre media chamber
4. Centre media chamber lid
5. Sponges
6. Pump
7. Pump strainer

INSTRUCTIONS FOR INSTALLATION AND USE

Important Safety Information - Please Read Carefully

- Always isolate from the mains electricity before installing or carrying out any maintenance to the Reef Filter unit.
- Power to the Reef Filter unit must be supplied through a Residual Current Device (RCD) with a rated residual operating current not exceeding 30mA.
- Pump rating: 230-240V, 50Hz unless marked otherwise.
- Do not operate any appliance if it has a damaged cord or plug, if it is malfunctioning, or if it has been dropped or damaged in any way.
- This unit is designed to be used indoors and is not suitable for any outdoor applications.
- Ensure the Reef Filter unit is safely positioned before operating.
- Always leave a drip-loop in the cables to prevent water running down the cable and reaching the power source (see below).
- Dispose of this unit responsibly. Check with your local authority for disposal information.

PLEASE READ CAREFULLY IF USING THIS UNIT WITH PHOSPHATE REMOVING MEDIA

If using phosphate removing media we highly recommend that it is **GENTLY** rinsed before use to remove excess dust etc.

PLEASE NOTE: The water flow to the filter must be carefully adjusted to ensure that the phosphate removing media is not being fluidised too vigorously and that the media is only gently fluidised. Failure to do so could result in over-abrasion of the phosphate removing media and fine particles or dust being passed into the aquarium or sump.

Check regularly that the filter is functioning properly and the phosphate removing media is being fluidised correctly i.e not too vigorously, and that the phosphate removing media is not clumping together. Replace phosphate removing media according to instructions provided with the media.

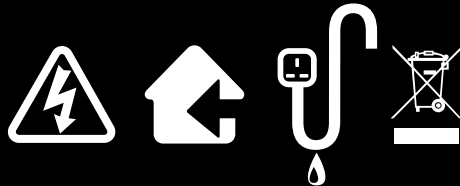

www.tropicalmarinecentre.com

Dispose of this unit responsibly. Check with your local authority for disposal information.

SET UP



1. Insert pump into the centre of the base of the Reef Filter.



2. Remove the centre media chamber from the Reef Filter and the lid.



3. Then remove the top sponge.



4. Fill the centre media chamber with the required volume of media.

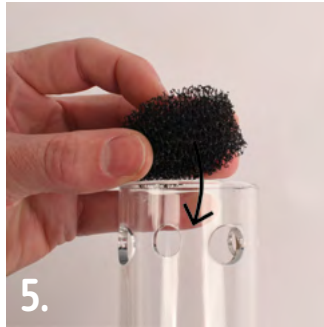

5. Replace the sponge back in the centre media chamber and then replace the lid, ensuring the seal is correctly positioned within its groove.



6. Place the centre media chamber back inside the main Reef Filter body.



7. Using the body hanger, hang the Reef Filter onto the aquarium or sump at the desired height using the thumb screw to secure it in place.

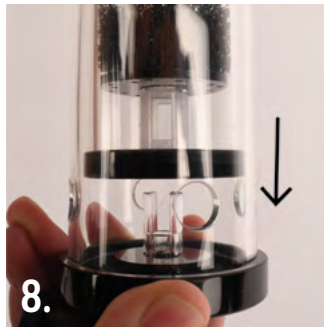

8. At the base of the reactor there is a built in flow control. By rotating the centre media chamber you can adjust the flow and fluidising level. For fine tuning of water flow, you can also adjust the water flow on the pump.



NOTE: Periodically clean the internal sponges and chambers to ensure continued even flow.

MAINTENANCE

CAUTION: ALWAYS ISOLATE THE PUMP FROM THE MAINS ELECTRICITY BEFORE INSTALLING OR CARRYING OUT ANY MAINTENANCE TO THE REEF FILTER.

The Reef Filter should need very little adjustment and maintenance once set up correctly. However due to factors such as organics, detritus, and in marine aquariums, the salt and calcium levels it is common for deposits to build up in and around the filter and therefore it is recommended that the filter is cleaned periodically.

1. To operate efficiently, the filter must be in use 24 hours a day.
2. Make sure all connections are tightly secured.
3. Check regularly if filter is functioning properly and the media is fluidising at the correct level.
4. Ensure all pipework is clean and free of blockages.
5. Clean filter chamber and sponge monthly or as required for optimal performance.
6. Clean your pump regularly to ensure it does not become clogged with debris or detritus (refer to pump instructions for full maintenance instructions).
7. If detritus enters the pump, you may need to rinse out or discard your media. This is why it is important to place the filter in a clean area of your aquarium.
8. When carrying out routine maintenance ensure that the filter lid O ring is correctly positioned and free from any dirt, detritus, salt and/or calcium deposits. Failure to do so could result in leaks.



USEFUL TIP: During routine maintenance it is advisable to ensure that the filter lid O ring is checked for any signs of degradation and replaced accordingly. Spares are available from your local stockist.

USEFUL TIP: For optimum results we recommend that the fluidising media is replaced or topped up as required, for example if there is a build up of dirt or detritus or if media is lost through over-fluidisation.

TROUBLE SHOOTING

Problem: THE FILTER MEDIA IS NOT FLUIDISING CORRECTLY

Possible Cause: Water flow rate to the filter is incorrect.

Solution: Adjust water flow to the filter accordingly.

Possible Cause: Pump is not plugged in or is not operating correctly.

Solution: Refer to the instructions supplied with your pump.

Possible Cause: Air is trapped inside the filter

Solution: Switch off your pump. Wait for a few minutes for the air to escape and the media to settle to the bottom of the filter and then switch the pump back on and adjust the water flow accordingly.

Possible Cause: Pipework is blocked.

Solution: Check for blockage and clean accordingly.

Possible Cause: The filter media needs replacing.

Solution: Replace filter media accordingly.

For details of all the products in our Reef Filter range please visit our website.

www.tropicalmarinecentre.com

or speak to your local TMC stockist.

Para obter detalhes de todos os produtos da nossa gama Reef Filter por favor visite o nosso website:

www.tropicalmarinecentre.com

ou contacte o seu agente local de vendas da TMC

Para más detalles sobre todos los productos de nuestra gama Reef Filter, visite la página web:

www.tropicalmarinecentre.com

o hable con su proveedor local de TMC.

Für Einzelheiten aller Produkte unserer Reef Filter Palette besuchen Sie bitte unsere Website:

www.tropicalmarinecentre.com

oder sprechen Sie mit Ihrem örtlichen TMC-Fachhändler.

Als u meer informatie wenst over alle producten in ons Reef Filter, aanbod breng dan een bezoek aan onze website:

www.tropicalmarinecentre.com

of raadpleeg uw plaatselijke TMC-verdeler.

Per ulteriori informazioni su tutti i prodotti della gamma Reef Filter, visitare il sito Web:

www.tropicalmarinecentre.com

o rivolgersi al proprio rivenditore TMC più vicino.

Pour le détail de tous les produits de notre gamme Reef Filter, veuillez consulter notre site Internetà:

www.tropicalmarinecentre.com

ou contacter votre stockiste TMC le plus proche.

Tropical Marine Centre

Solesbridge Lane, Chorleywood, Hertfordshire, WD3 5SX, UK

Tel: +44(0) 1923 284151 Fax: +44(0) 1923 285840

www.tropicalmarinecentre.com

info@tropicalmarinecentre.co.uk



tropicalmarinecentre.com

info@tropicalmarinecentre.co.uk

UK

Solesbridge Lane
Chorleywood
Hertfordshire WD3 5SX
England

Call +44 [0] 1923 284151

Iberia

Rua Cidade de Paris 6
Parque Industrial do Arneiro
2660-456 São Julião do Tojal
Portugal

Call +351 [0] 219 739 140

